

Capital Planning, Project and Vote Facts

Vote date 12/10/15 at the Jr/Sr High School Gym lobby from Noon to 9:00 PM.

Capital Planning Program Estimates:

Gross cost before aid, grants, and other special funding:

HS additions/alterations/renovations \$21.8 million

Elementary additions/alterations/renovations \$3.5 million

New Bus Garage (utilities, building, roadways, parking) \$3.2 million

Campus wide site work (roads, utilities, playing fields, ground, etc.) \$5.0 million

State aid reimbursement for approved aided expenditures for Mechanicville is currently 78.1%.

The current high school plan is diversified including a new science wing, new art, chorus and band renovations and enlarged spaces, a new softball field and a new exhibition field to name a few of the many improvements. Virtually every classroom in the high school will get a "make over".

Technology upgrades and updates are a major initiative in the plan. State of the art infrastructure and hardware/software improvements are planned at every grade level and subject area in the Jr/Sr High School.

Heating/cooling and roofing work are in the project. Building-wide electrical work and badly needed plumbing work are included as well.

The capital program will take several years to complete. It will be done in phases with the high school phase beginning first. The estimated construction start would be the summer of 2017.

The estimated budget costs are maximums and only the money actually needed will be borrowed. To calculate the impact on your taxes in the first year (17-18 school year) you could multiply .02 (as an estimate of the first year's net impact on local property tax increase, on average) times your latest school tax paid. Another example is to assume a home, in the district, in say Halfmoon is assessed at \$100,000. Then the calculation for an estimated tax increase for the project at this year's tax rate would be: $\$100,000 \times .02860016 \text{ tax rate} \times .02 \text{ increase} = \$57.20 \text{ per year or } \$4.76/\text{month}$ in the 17-18 school year.

Remember, this is an estimate of the first year tax impact as an average across the four district municipalities.



New sidewalk

Demo existing bus garage

New bus and parent drop off

Dumpster / emergency parking

New artificial turf field

Resurface running track

Enlarge / new storage bldg

Roadway curb and sidewalk

Improve field drainage

New sidewalk

New bldg additions - (RED)

Parking lot and driveway improvements



New driveway access

New bus garage and parking lot

New softball field

Raised walkway through woodland / swamp

New soccer field

Visitor bleachers

New outdoor plaza

Fire lane / path

New bldg additions - (RED)

Remove existing parking lot and provide new Administration parking lot

New walkway to stairs

CONCEPT PLAN

A
B
C
D
E
F
G
H
I
J
K

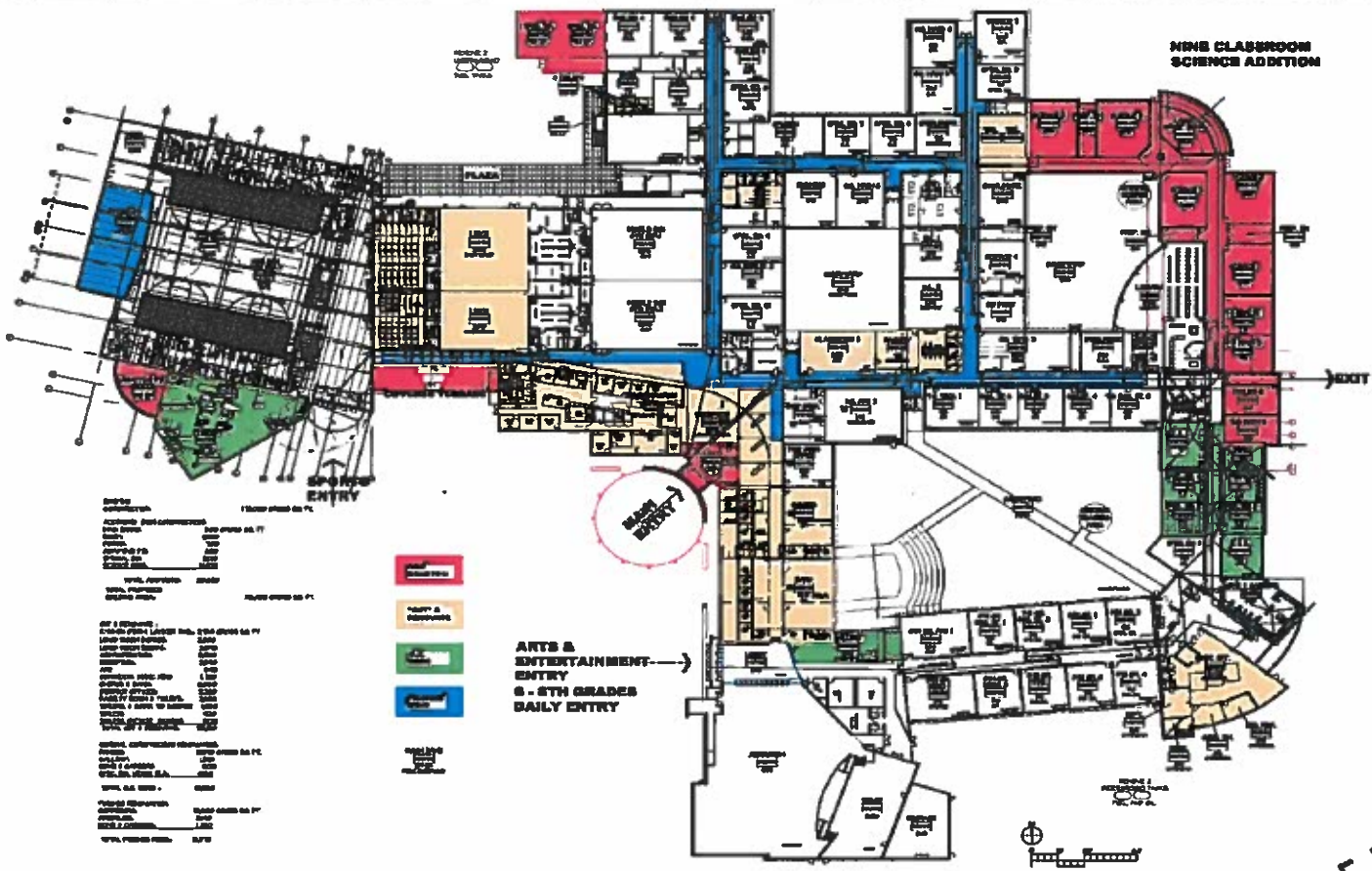

- Notes**
- 1. See Structural Steel Detailing for details of steel framing.
 - 2. See Mechanical Schedule for details of mechanical systems.
 - 3. See Electrical Schedule for details of electrical systems.
 - 4. See Plumbing Schedule for details of plumbing systems.
 - 5. See Fire Protection Schedule for details of fire protection systems.
 - 6. See Civil Engineering Schedule for details of civil engineering systems.
 - 7. See Landscape Architecture Schedule for details of landscape architecture systems.
 - 8. See Interior Design Schedule for details of interior design systems.
 - 9. See Furniture Schedule for details of furniture systems.
 - 10. See Lighting Schedule for details of lighting systems.
 - 11. See Acoustics Schedule for details of acoustics systems.
 - 12. See Security Schedule for details of security systems.
 - 13. See Accessibility Schedule for details of accessibility systems.
 - 14. See Sustainability Schedule for details of sustainability systems.
 - 15. See Construction Schedule for details of construction systems.
 - 16. See Commissioning Schedule for details of commissioning systems.
 - 17. See Operations Schedule for details of operations systems.
 - 18. See Maintenance Schedule for details of maintenance systems.
 - 19. See Safety Schedule for details of safety systems.
 - 20. See Quality Assurance Schedule for details of quality assurance systems.

Room Type Legend

- Classroom
- Arts & Recreation
- Gymnasium
- Other

ARTS & ENTERTAINMENT ENTRY
9 - 8TH GRADES DAILY ENTRY

NINE CLASSROOM SCIENCE ADDITION

K1 FLOOR PLAN
SCALE: 1" = 32' SEE SECTION MARKS

8/17/15 DRAFT

<p>MECHANICVILLE CITY SCHOOL DISTRICT JR./SR. HIGH SCHOOL 25 KIRKMAN AVENUE MECHANICVILLE, NEW YORK SIC PROJECT NO. 12-12-00-05-0-006-01X</p>	
<p>BONACCI ARCHITECTS</p>	
<p>FLOOR PLAN SKETCH #3</p>	
<p>DATE: 8/17/15</p>	<p>SCALE: 1" = 32'</p>
<p>PROJECT NO. 12-12-00-05-0-006-01X</p>	<p>ARCHITECT: SKF3</p>

Capital Planning Bond Authorization Summary

I. Cost of Capital Planning Program (today)

High School Additions/Renovations	21.8 million
Site Work (fields, roads, utilities, walkways, ect.)	5.0 million
New Bus Garage (utilities, building, ect.)	3.2 million
Elementary Building Additions	3.5 million

Notes:

1. Gross cost of estimated work
2. Expect actual debt to be less
3. Will get significant S.A. so net will be less, currently getting a reimbursement ratio of 78.1% on approved aided expenditures.
4. Borrowing will be done as needed during construction years.

II. This is a planning process which will be done (assessments and planning) yearly now, not once a decade or more.